

Interchangeable inserts 1:7.5

for high performance live centres

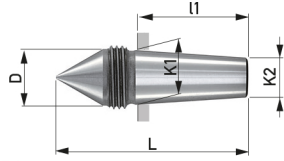

Form A0, 60°
with draw-off nut



Form ASL,
slim,
with draw-off nut

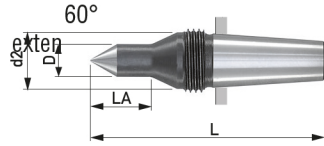

Form AKOP, 60°/40°
extended
with draw-off nut

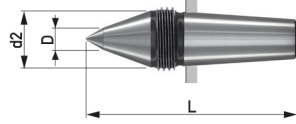

Form A, 60°
for hollow parts
spanner flat (SW)

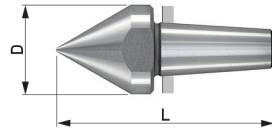

Form B, centre 60°
for centreless workpieces,
with draw-off nut

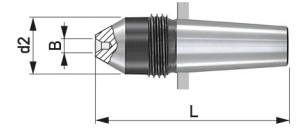

Form C, centre 60°
for centreless workpieces,
external angle 60° for hollow
parts, spanner flat (SW)

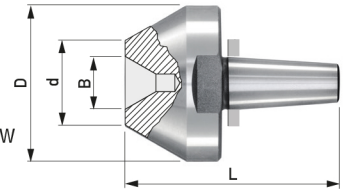

Form D, centre 60°
for centreless workpieces,
spanner flat (SW)

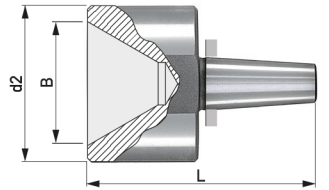

Form AOHM, 60°
with carbide insert
with draw-off nut

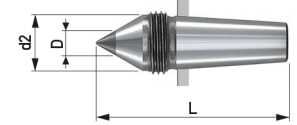

Interchangeable inserts	Workpiece weight max. daN	Insert dimensions						Thread SW	Taper dimensions		
		D	d2	B	d	L	LA		taper 1:7.5		
ID.No.								K1	K2	l1	
482AO	90	11.7				45		11	8	23	
482ASL	30	6	11.7			55	15				
482AKOP	90	5	11.7			50					
482A	90	17				45					
482B	90		11.7	4x2		45					
482C	90	28		8x3	12	45					
482D	90		28	20x6		45					
482AOHM	60	7	11.7			45		15	11	30	
484AO	160	15.7				53					
484ASL	100	9	15.7			65	17				
484AKOP	160	6	15.7			58					
484A	160	25				60					
484B	110		15.7	4x2		53					
484C	160	44		15x5	24	60					
484D	160		44	35x12		64					
484AOHM	60	7	15.7			53		22	16.4	42	
487AO	300	21.6				74					
487ASL	100	9	21.6			86	17				
487AKOP	300	8	21.6			80					
487A	300	32				82					
487B	240		21.6	5x2.5		74					
487C	300	55		20x6	30	82					
487D	300		55	45x15		85					
487AOHM	200	11	21.6			74		28	21	52.5	
485AO	500	27.7				93					
485ASL	180	13	27.7			110	27				
485AKOP	500	8	27.7			105					
485A	500	45				105					
485B	500		27.7	7x3		93					
485C	500	65		25x6	35	105					
485D	500		65	55x20		105					
485AOHM	500	18	27.7			93					

ID.No.	Content
P 10	100 g

Installation paste

Makes insert change easier.
Apply thinly and evenly to the insert taper.