

Type LRE

Spring loaded centre spindle with 1:7.5 internal taper for interchangeable inserts. Pressure indication by coloured rings

Runout

max. 0.005 mm, with test report
max. 0.003 mm, high precision design on request

Application

Turning, CNC turning with multi-spindle machines or CNC lathes with twin tool turrets.
As a tailstock centre when using face drivers.

Advantages

As the centrepoint wears only the insert has to be changed and once again the high performance centre is ready for use. Flexibility in application is made possible by a choice of eight different insert styles.

Depending on the style the insert can be removed by its draw-off thread and draw-off nut or with spanners applied to the spanner flats.

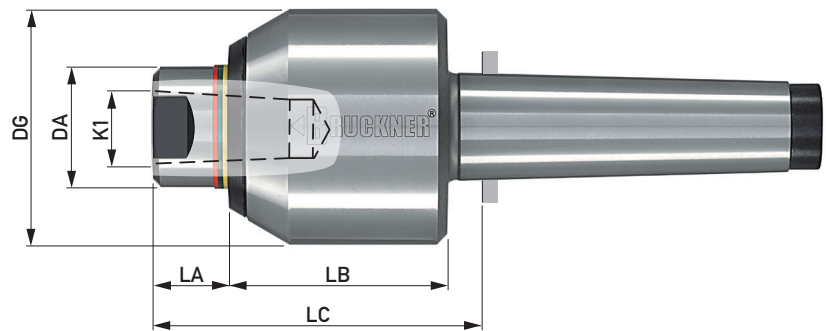

Type LRE	ID.No.	700E 055003	700E 068004	700E 092005
Morse taper		3	4	5
DA		25	35	50
K1		15	22	28
DG		55	68	92
LA		15	21	28
LB		51	63	82
LC		71	89	116
Spring travel		2.7	4.2	5.4
r.p.m. max.		5000	4000	3500
Suitable inserts		484..	487..	485..
Load	The radial load of type LRE is restricted by the interchangeable inserts			
Axial force per coloured ring				

Available with draw-off thread and draw-off nut (design A)
MT2 on request (700E 045002)

Interchangeable inserts

taper 1:7.5, in gauge accuracy

Form AO, 60°
with draw-off nut

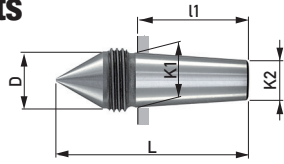

Form ASL, 60°
slim, extended
with draw-off nut

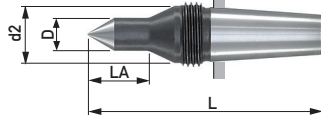

Form AKOP, 60°/40°
extended
with draw-off nut

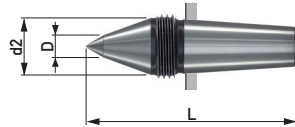

Form A, 60°
for hollow parts
spanner flat (SW)

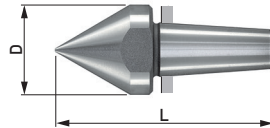

Form B, centre 60°
for centreless workpieces,
with draw-off nut

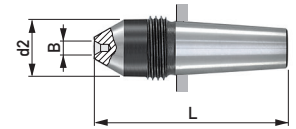

Form C, centre 60°
for centreless workpieces,
external angle 60° for hollow
parts, spanner flat (SW)

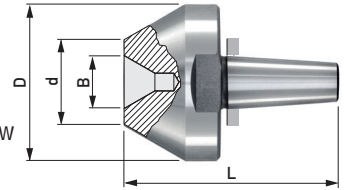

Form D, centre 60°
for centreless workpieces,
spanner flat (SW)

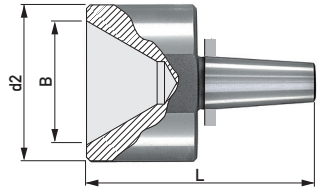

Form AOHM, 60°
with carbide insert
with draw-off nut

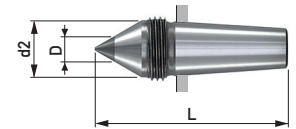

Basic body Type: LRE	Interchangeable inserts	Workpiece weight max. daN	Insert dimensions						Thread SW	Taper dimensions taper 1:7.5		
			D	d2	B	d	L	LA		K1	K2	I1
700E 055003	484AO	160	15.7				53		M18x1.5	15	11	30
	484ASL	100	9	15.7		65	17	M18x1.5				
	484AKOP	160	6	15.7		58		M18x1.5				
	484A	160	25			60		SW22				
	484B	110		15.7	4x2	53		M18x1.5				
	484C	160	44		15x5	24	60	SW41				
	484D	160		44	35x12		64	SW41				
700E 068004	484AOHM	60	7	15.7		53		M18x1.5	22	16.4	42	
	487AO	300	21.6			74		M24x1.5				
	487ASL	100	9	21.6		86	17	M24x1.5				
	487AKOP	300	8	21.6		80		M24x1.5				
	487A	300	32			82		SW27				
	487B	240		21.6	5x2.5	74		M24x1.5				
	487C	300	55		20x6	30	82	SW50				
700E 092005	487D	300		55	45x15		85	SW50	28	21	52.5	
	487AOHM	200	11	21.6		74		M24x1.5				
	485AO	500	27.7			93		M30x1.5				
	485ASL	180	13	27.7		110	27	M30x1.5				
	485AKOP	500	8	27.7		105		M30x1.5				
	485A	500	45			105		SW41				
	485B	500		27.7	7x3	93		M30x1.5				
485C	500	65		25x6	35	105	SW55					
485D	500		65	55x20		105	SW55					
485AOHM	500	18	27.7			93	M30x1.5					

ID.No.	Content
P 10	100 g

Installation paste

Makes insert change easier.
Apply thinly and evenly to the insert taper.