

Type LDE

Centre spindle with 1:7.5 internal taper for interchangeable inserts. Spring loaded for expansion compensation, without pressure indication

Runout

max. 0.005 mm, with test report
max. 0.003 mm, high precision design on request

Application

Turning, CNC turning

Advantages

As the centrepoint wears only the insert has to be changed and once again the high performance centre is ready for use. Flexibility in application is made possible by a choice of eight different insert styles. Depending on the style the insert can be removed by its draw-off thread and draw-off nut or with spanners applied to the spanner flats.

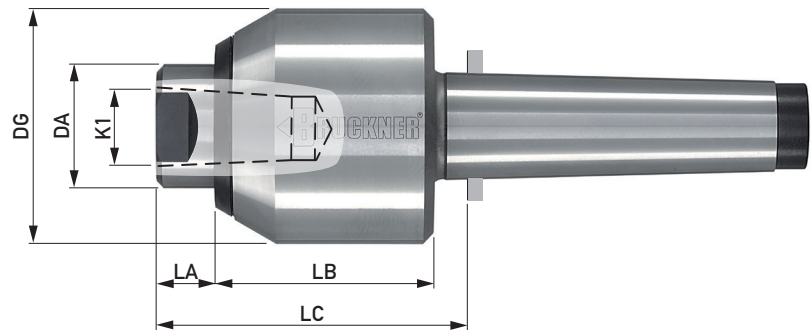

Type LDE	ID.No.	710E 045002	710E 055003	710E 068004	710E 092005
Morse taper		2	3	4	5
DA		19	26	36	51
K1		11	15	22	28
DG		45	55	68	92
LA		9	14	18	20
LB		45	51	63	82
LC		57	70	86	107
Spring travel		0.85	0.95	1.4	1.8
r.p.m. max.		5500	5000	4000	3500
Suitable inserts		482..	484..	487..	485..
Load	The radial load of type LDE is restricted by the interchangeable inserts				

Available with draw-off thread and draw-off nut (design A)



Interchangeable inserts

taper 1:7.5, in gauge accuracy

Form AO, 60°
with draw-off nut

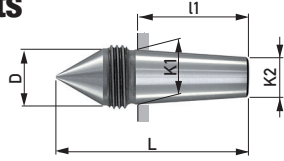

Form ASL, 60°
slim, extended
with draw-off nut

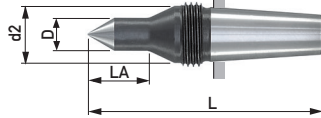

Form AKOP, 60°/40°
extended
with draw-off nut

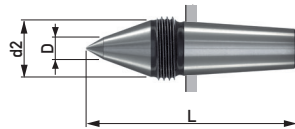

Form A, 60°
for hollow parts
spanner flat (SW)

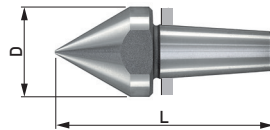

Form B, centre 60°
for centreless workpieces,
with draw-off nut

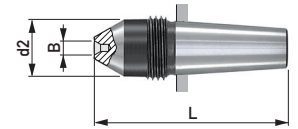

Form C, centre 60°
for centreless workpieces,
external angle 60° for hollow
parts, spanner flat (SW)

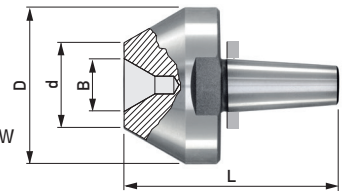

Form D, centre 60°
for centreless workpieces,
spanner flat (SW)

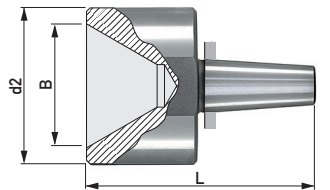

Form AOHM, 60°
with carbide insert
with draw-off nut

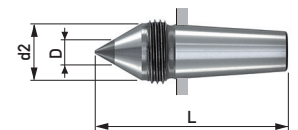

Basic centre Types: LDE, TRE	Interchangeable inserts	Workpiece weight max. daN	Insert dimensions						Thread SW	Taper dimensions taper 1:7.5		
			D	d2	B	d	L	LA		K1	K2	I1
710E 045002	482AO	90	11.7				45		M14x1.5	11	8	23
	482ASL	30	6	11.7			55	15	M14x1.5			
	482AKOP	90	5	11.7			50		M14x1.5			
	482A	90	17				45		SW14			
	482B	90		11.7	4x2		45		M14x1.5			
	482C	90	28		8x3	12	45		SW24			
	482D	90		28	20x6		45		SW24			
	482AOHM	60	7	11.7			45		M14x1.5			
710E 055003	484AO	160	15.7				53		M18x1.5	15	11	30
700E 055VDI30 700E 055CO4 700E 055HSK-C40 (-R) 700E 055HSK-C50 (-R) 700E 055Zyl25.4 700E 055Zyl25 700E 055Zyl32	484ASL	100	9	15.7			65	17	M18x1.5			
	484AKOP	160	6	15.7			58		M18x1.5			
	484A	160	25				60		SW22			
	484B	110		15.7	4x2		53		M18x1.5			
	484C	160	44		15x5	24	60		SW41			
	484D	160		44	35x12		64		SW41			
	484AOHM	60	7	15.7			53		M18x1.5			
	710E 068004	487AO	300	21.6				74				
700E 068VDI40 700E 068CO5 700E 068CO6 700E 068Zyl32 700E 068Zyl40	487ASL	100	9	21.6			86	17	M24x1.5			
	487AKOP	300	8	21.6			80		M24x1.5			
	487A	300	32				82		SW27			
	487B	240		21.6	5x2,5		74		M24x1.5			
	487C	300	55		20x6	30	82		SW50			
	487D	300		55	45x15		85		SW50			
	487AOHM	200	11	21.6			74		M24x1.5			
	710E 092005	485AO	500	27.7				93		M30x1.5	28	21
700E 092005	485ASL	180	13	27.7			110	27	M30x1.5			
	485AKOP	500	8	27.7			105		M30x1.5			
	485A	500	45				105		SW41			
	485B	500		27.7	7x3		93		M30x1.5			
	485C	500	65		25x6	35	105		SW55			
	485D	500		65	55x20		105		SW55			
	485AOHM	500	18	27.7			93		M30x1.5			

ID.No.	Content
P 10	100 g

Installation paste

Makes insert change easier.
Apply thinly and evenly to the insert taper.