

HSK-C shank

Type TRE – centre spindle with internal taper 1:7.5 for interchangeable inserts

Types TRS (60°), TRV (60°/40°) on request

Runout

max. 0.005 mm, with test report
max. 0.003 mm, high precision design on request

Range of axial force per coloured ring

Standard spring force	daN 0-250	250-500	500-850
Recuded spring force	daN 0-130	130-250	250-320

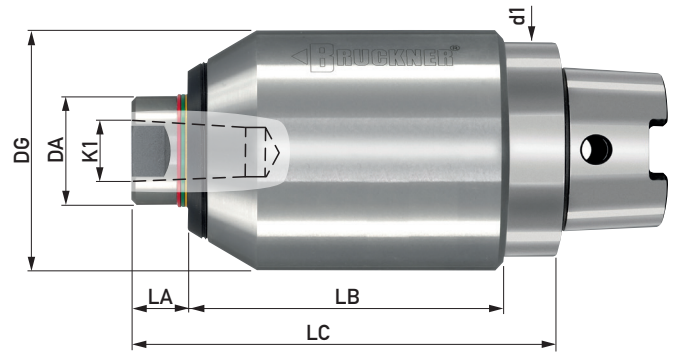

Type TRE	ID-Nr.	700E 055HSK-C40	700E 055HSK-C40-R	700E 055HSK-C50	700E 055HSK-C50-R
Shaft size HSK-C (d1)		40	40	50	50
Spring force		standard	reduced	standard	reduced
DG		55	55	55	55
DA		25	25	25	25
K1		15	15	15	15
LA		13	13	13	13
LB		73	73	73	73
LC		96	96	97	97
Spring travel		2,7	2,3	2,7	2,3
r.p.m. max.		5000	5000	5000	5000
Suitable inserts		484..	484..	484..	484..
Load	The radial load of type TRE is limited by the interchangeable inserts				

Cylindrical shank

Type TRE – centre spindle with internal taper 1:7.5 for interchangeable inserts

Types TRS (60°), TRV (60°/40°) on request

Runout

max. 0.005 mm, with test report
max. 0.003 mm, high precision design on request

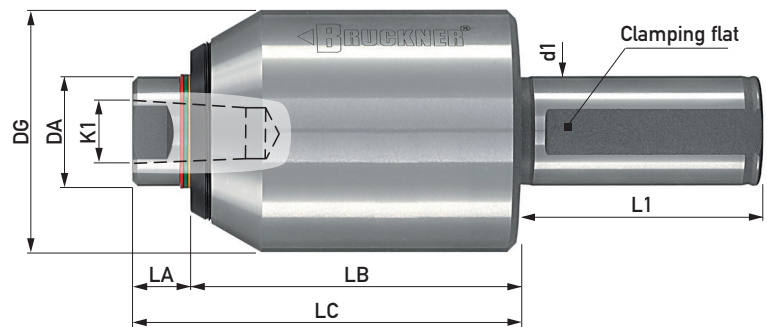

Type TRE	ID.No.	700E 055Zyl25.4	700E 055Zyl25	700E 055Zyl32	700E 068Zyl32	700E 068Zyl40
Shaft size d1		25.4 (1")	25	32	32	40
DG		55	55	55	68	68
DA		25	25	25	35	35
K1		15	15	15	22	22
LA		13	13	13	21	21
LB		74	74	74	89	89
LC		87	87	87	110	110
L1		55	55	65	65	80
Spring travel		2.7	2.7	2.7	4.2	4.2
r.p.m. max.		5000	5000	5000	4000	4000
Suitable inserts		484..	484..	484..	487..	487..
Load	The radial load of type TRE is limited by the interchangeable inserts					

Interchangeable inserts

taper 1:7.5, in gauge accuracy

Form AO, 60°
with draw-off nut

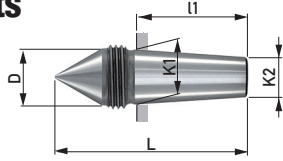

Form ASL, 60°
slim, extended
with draw-off nut

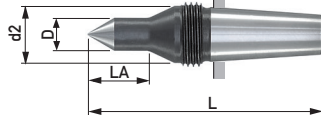

Form AKOP, 60°/40°
extended
with draw-off nut

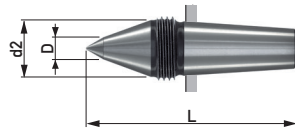

Form A, 60°
for hollow parts
spanner flat (SW)

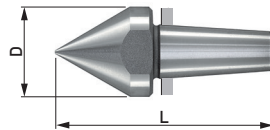

Form B, centre 60°
for centreless workpieces,
with draw-off nut

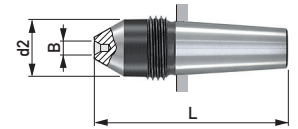

Form C, centre 60°
for centreless workpieces,
external angle 60° for hollow
parts, spanner flat (SW)

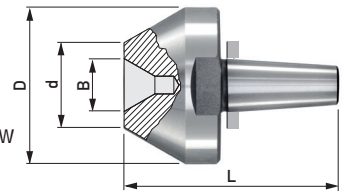

Form D, centre 60°
for centreless workpieces,
spanner flat (SW)

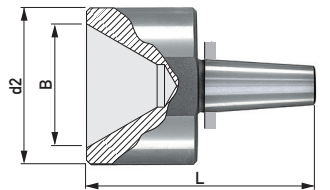

Form AOHM, 60°
with carbide insert
with draw-off nut

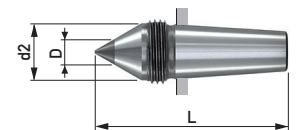

Basic centre Types: LDE, TRE	Interchangeable inserts	Workpiece weight max. daN	Insert dimensions						Thread SW	Taper dimensions taper 1:7.5		
			D	d2	B	d	L	LA		K1	K2	I1
710E 045002	482AO	90	11.7				45		M14x1.5	11	8	23
	482ASL	30	6	11.7			55	15	M14x1.5			
	482AKOP	90	5	11.7			50		M14x1.5			
	482A	90	17				45		SW14			
	482B	90		11.7	4x2		45		M14x1.5			
	482C	90	28		8x3	12	45		SW24			
	482D	90		28	20x6		45		SW24			
	482AOHM	60	7	11.7			45		M14x1.5			
710E 055003 700E 055VDI30 700E 055CO4 700E 055HSK-C40 (-R) 700E 055HSK-C50 (-R) 700E 055Zyl25.4 700E 055Zyl25 700E 055Zyl32	484AO	160	15.7				53		M18x1.5	15	11	30
	484ASL	100	9	15.7			65	17	M18x1.5			
	484AKOP	160	6	15.7			58		M18x1.5			
	484A	160	25				60		SW22			
	484B	110		15.7	4x2		53		M18x1.5			
	484C	160	44		15x5	24	60		SW41			
	484D	160		44	35x12		64		SW41			
	484AOHM	60	7	15.7			53		M18x1.5			
	710E 068004 700E 068VDI40 700E 068CO5 700E 068CO6 700E 068Zyl32 700E 068Zyl40	487AO	300	21.6				74				
487ASL		100	9	21.6			86	17	M24x1.5			
487AKOP		300	8	21.6			80		M24x1.5			
487A		300	32				82		SW27			
487B		240		21.6	5x2,5		74		M24x1.5			
487C		300	55		20x6	30	82		SW50			
487D		300		55	45x15		85		SW50			
487AOHM		200	11	21.6			74		M24x1.5			
710E 092005		485AO	500	27.7				93		M30x1.5	28	21
	485ASL	180	13	27.7			110	27	M30x1.5			
	485AKOP	500	8	27.7			105		M30x1.5			
	485A	500	45				105		SW41			
	485B	500		27.7	7x3		93		M30x1.5			
	485C	500	65		25x6	35	105		SW55			
	485D	500		65	55x20		105		SW55			
	485AOHM	500	18	27.7			93		M30x1.5			

ID.No.	Content
P 10	100 g

Installation paste

Makes insert change easier.
Apply thinly and evenly to the insert taper.