

Carbide Dead Centres, Half Centre 60°

without Draw-Off Thread

Form HE – HL – HS – HV

Out-of-roundness $\square \leq 0.8\mu\text{m}$. Morse taper hardened for protection from damage. Quality features

Form	Morse taper	ID.No.	D	d2	H	LH	LC	L
HE	1	2811H	7	12.2	4	22	26.5	80
	2	2812H	7	18	4	30	36	100
	3	2813H	11	24.1	6	38	44	125
	4	2814H	14	31.6	7.5	50	57.5	160
	5	2815H	18	44.7	9.5	63	70.5	200

Form HE
similar to DIN 806 HE

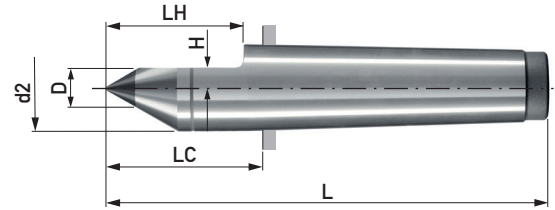

Form	Morse taper	ID.No.	D	d2	H	LH	LC	L
HL	2	2812.11-135	11	18	6	65	71	135
	2	2812.14	14	18	7.5	30	36	100
	3	2813.14	14	24.1	7.5	38	44	125
	3	2813.14-150	14	24.1	7.5	63	69	150
	3	2813.18	18	28	9.5	40	47	128
	4	2814.18	18	31.6	9.5	50	57.5	160
	4	2814.18-180	18	31.6	9.5	70	77.5	180
	4	2814.18-200	18	31.6	9.5	90	97.5	200
	5	2815.18-250	18	44.7	9.5	113	120.5	250

Form HL
larger carbide diameter,
length to DIN and extended

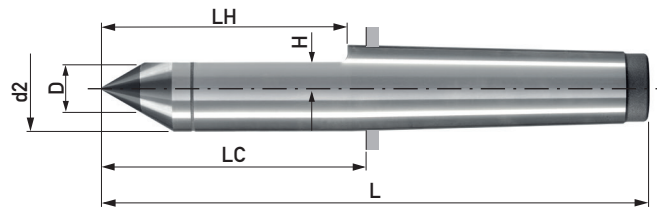

Form	Morse taper	ID.No.	D	d2	H	LH	LC	L
HS	2	2812H/1,5	7	18	1.5	40	46	110
	2	2812H/2,5	7	18	2.5	40	46	110
	3	2813H/1,5	11	24.1	1.5	63	69	150
	3	2813H/2,5	11	24.1	2.5	63	69	150
	3	2813H/4,0	11	24.1	4.0	63	69	150
	4	2814H/1,5	14	31.6	1.5	70	77.5	180
	4	2814H/2,5	14	31.6	2.5	70	77.5	180
	4	2814H/4,0	14	31.6	4.0	70	77.5	180

Form HS
extra flat height, extended

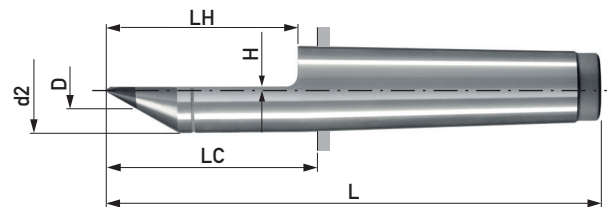

Form	Morse taper	ID.No.	D	H	LH	LC	L
HV	3	2813.24V/H5-150	24.1	5	63	69	150
	3	2813.24V/H7.5-150	24.1	7.5	63	69	150
	4	2814.32V/H5-200	31.6	5	90	97.5	200
	4	2814.32V/H9-200	31.6	9	90	97.5	200

Form HV
extra flat height, solid carbide point with
safety core **sa•co**[®]

